

SPECIFICATIONS

Features

- Constant Current Output
- 0-10V Dimming
- Class II Compliance
- Damp Location
- 5 Year Warranty
- Hot Wire Protection
- Supporting DIM TO OFF Capability

Wiring Diagram

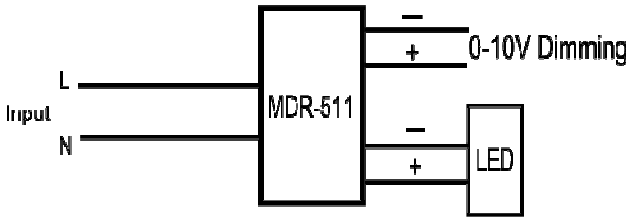

Mechanical and Thermal

Dimensions	L3.878" x W2.047" x H1.171"
Weight	285 g
Lead Wire Length	6" (Standard)
Max. Case Operation Temp.	80°C

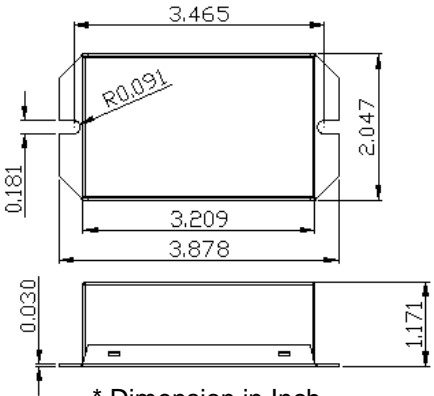

* Dimension in Inch

Protection

- Auto-reset electronic short circuit
- Overload protection
- Class II
- Inherent Thermal Protection

Environmental Specifications

- Operating Temperature -20° to 60°C
- Storage Temperature -20° to 70°C
- MTBF >100,000 hrs
- Lead Free SMT process

Electrical

Maximum Load	23W
Input Voltage	120 – 277V/50-60Hz
Output Voltage	28-42VDC
Output Current (max.)	500mA
Power Factor	>0.90 (16-23W)
Efficiency	80 typ.
No Load Loss	<1 W



Note –

1. UL file No.: E340871
2. Driver is designated for “Stand by mode” at minimum light intensity (<0.8Vdc) power will not be OFF.

